

PLAN VIEW

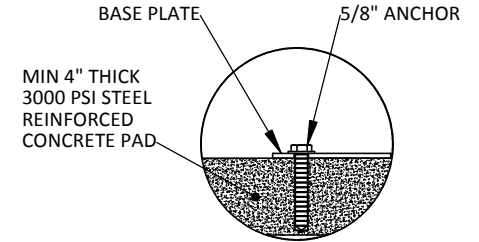
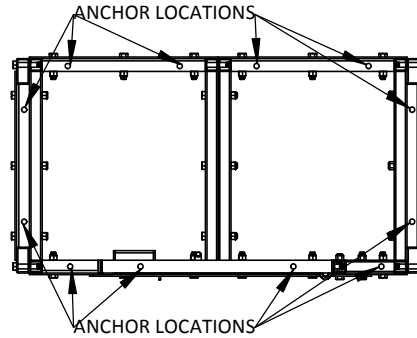
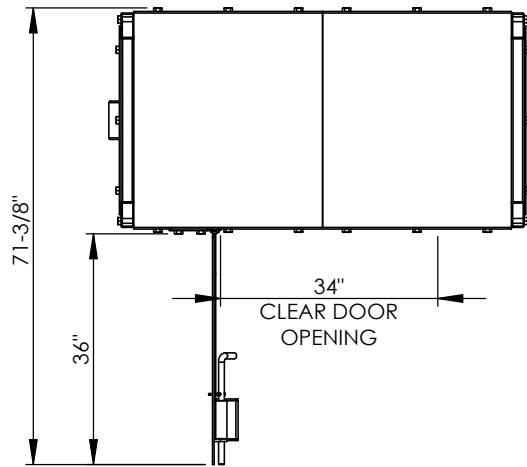

ANCHOR DETAIL

**FEATURES**

- INTERIOR FLOOR DIMENSIONS / AREA  
- 4' - 11" x 2' - 5-1/2" / 12.1 SF
- WALL, CEILING AND DOOR PANELS  
- 1/4" STEEL PLATE
- WALL AND CEILING PANEL REINFORCEMENT  
- 2"x2"x3/16" SQUARE TUBES WELDED TO WALL PANEL
- DOOR PANEL REINFORCEMENT  
- 1/4" STEEL PLATES WELDED TO DOOR PANEL
- DOOR HINGE  
- CONTINUOUS HINGE WITH 1-3/4" X 9" KNUCKLES  
- 15/16" DIA. SOLID STEEL HINGE PIN  
- CONNECTIONS MADE WITH WELDED SPLINE JOINTS
- DOOR LOCKING SYSTEM  
- THREE 15/16" DIA. SLIDE BARS
- FASTENERS  
- 3/4" DIA GRADE 5 BOLTS
- ANCHORING SYSTEM  
- 5/8" DIA. POWERS WEDGE-BOLT+ SCREW ANCHORS
- FIELD REVERSIBLE DOOR SWING
- POWDER COATED FINISH
- GROUNDING TERMINAL

DESIGNED AND CONSTRUCTED IN ACCORDANCE WITH  
FEMA 361/320 AND ICC-500-2008

TESTED AND APPROVED BY WIND SCIENCE & ENGINEERING  
RESEARCH CENTER - DEBRIS IMPACT TEST FACILITY

ATSA (AMERICAN TORNADO SHELTER ASSOC) LISTED

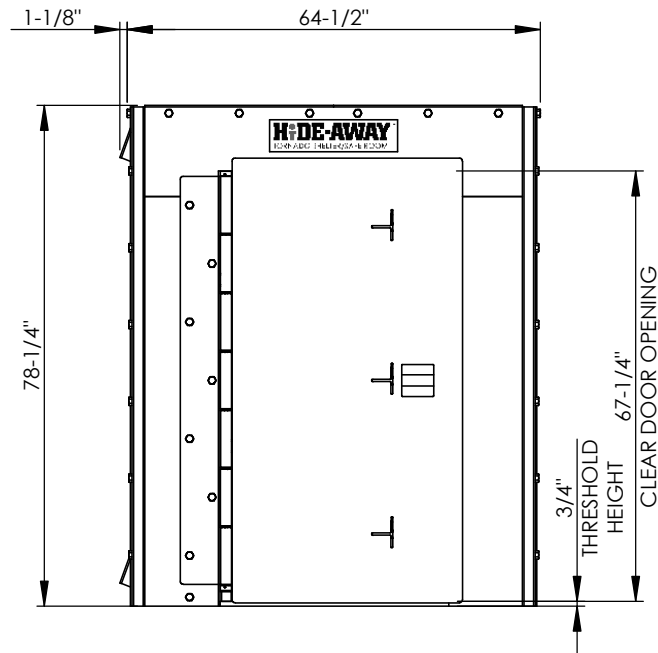

FRONT ELEVATION VIEW

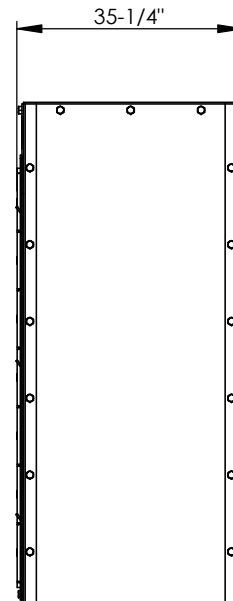

SIDE ELEVATION VIEW

NOTE:  
ALL DIMENSIONS AND/OR TECHNICAL INFORMATION ARE  
SUBJECT TO CHANGE WITHOUT NOTICE, CONTACT YOUR  
LOCAL DEALER OR STAYING HOME CORPORATION FOR  
VERIFICATION.

 Staying Home Corporation 1503 Vine Street Harrisonville, MO 64701 816-380-2427 www.stayinghome.com		Your Aging in Place Resource	
		MODEL: STORM SHELTER / FIXED-2X1	
 TORNADO SHELTER/SAFE ROOM		DWG. NO. TYP-FX2X1	
SCALE: NTS	12/11/2013	SHEET 1 OF 1	