

PLAN VIEW

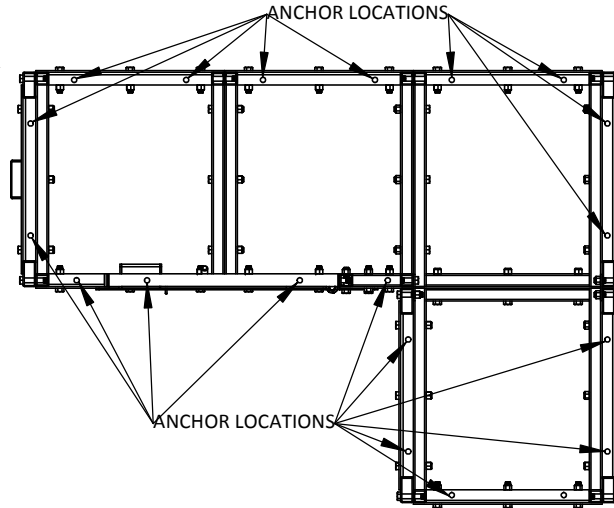

BASE PLATE 5/8" ANCHOR

MIN 4" THICK
3000 PSI STEEL
REINFORCED
CONCRETE PAD

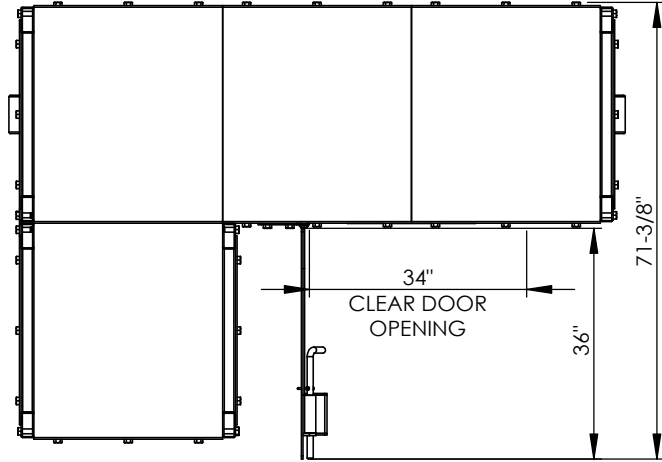
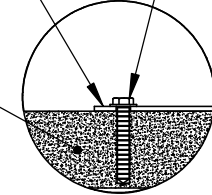

ANCHOR DETAIL

FEATURES

- INTERIOR FLOOR DIMENSIONS / AREA
 - 7' - 4-1/2" x 2' - 5-1/2" / 18.1 SF
- WALL, CEILING AND DOOR PANELS
 - 1/4" STEEL PLATE
- WALL AND CEILING PANEL REINFORCEMENT
 - 2"x2"x3/16" SQUARE TUBES WELDED TO WALL PANEL
- DOOR PANEL REINFORCEMENT
 - 1/4" STEEL PLATES WELDED TO DOOR PANEL
- DOOR HINGE
 - CONTINUOUS HINGE WITH 1-3/4" X 9" KNUCKLES
 - 15/16" DIA. SOLID STEEL HINGE PIN
 - CONNECTIONS MADE WITH WELDED SPLINE JOINTS
- DOOR LOCKING SYSTEM
 - THREE 15/16" DIA. SLIDE BARS
- FASTENERS
 - 3/4" DIA GRADE 5 BOLTS
- ANCHORING SYSTEM
 - 5/8" DIA. POWERS WEDGE-BOLT+ SCREW ANCHORS
- FIELD REVERSIBLE DOOR SWING
- POWDER COATED FINISH
- GROUNDING TERMINAL

DESIGNED AND CONSTRUCTED IN ACCORDANCE WITH
FEMA 361/320 AND ICC-500-2008

TESTED AND APPROVED BY WIND SCIENCE & ENGINEERING
RESEARCH CENTER - DEBRIS IMPACT TEST FACILITY

ATSA (AMERICAN TORNADO SHELTER ASSOC) LISTED

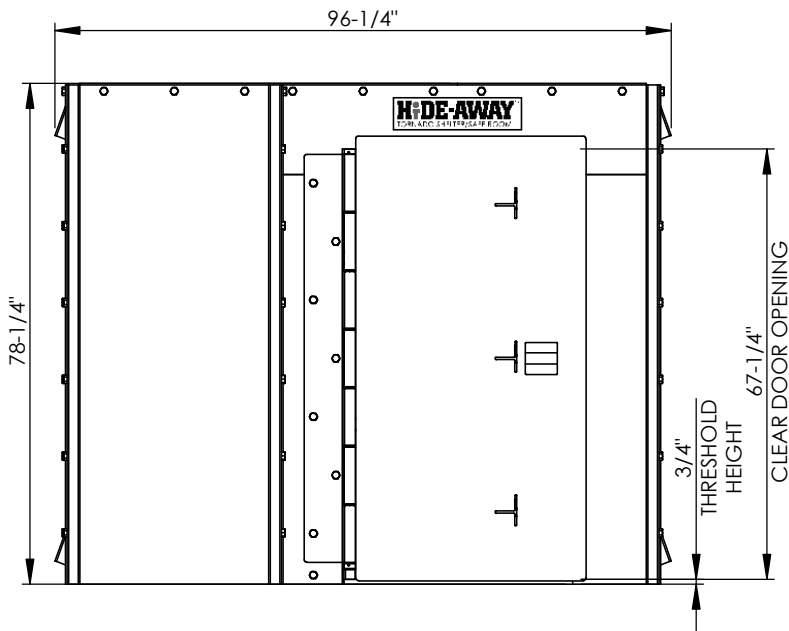

FRONT ELEVATION VIEW

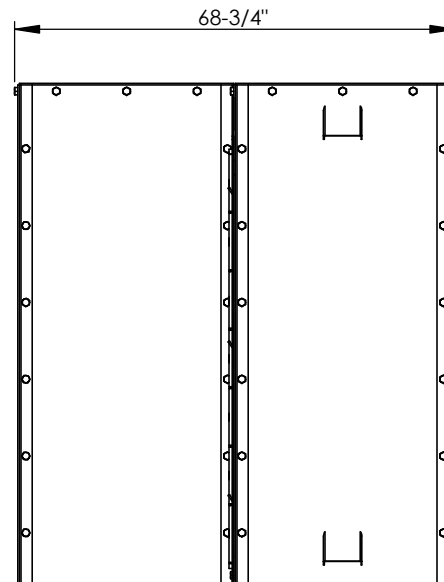

SIDE ELEVATION VIEW

NOTE:
ALL DIMENSIONS AND/OR TECHNICAL INFORMATION ARE
SUBJECT TO CHANGE WITHOUT NOTICE, CONTACT YOUR
LOCAL DEALER OR STAYING HOME CORPORATION FOR
VERIFICATION.

Staying Home Corporation
1503 Vine Street
Harrisonville, MO 64701
816-380-2427
www.stayinghome.com

MODEL:
STORM SHELTER / FIXED-3X1L

HIDE-AWAY™ DWG. NO.
TORNADO SHELTER/SAFE ROOM TYP-FX3X1L

SCALE: NTS 12/11/2013 SHEET 1 OF 1